

HP HIGH PERFORMANCE™

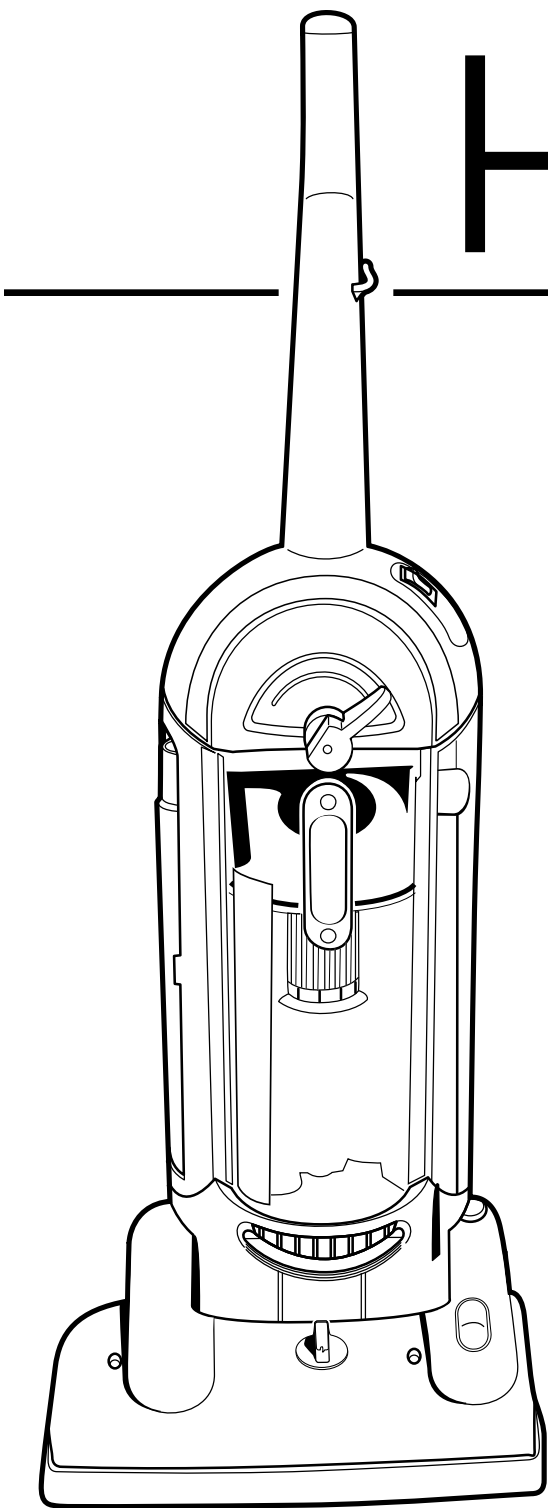

Upright Vacuum Cleaner

Household Type

OWNER'S GUIDE

HP5550 Series

IMPORTANT

Do not return to the store. For assembly problems or questions, for replacement of broken or missing items, or to order replacement parts and accessories to be shipped direct to you contact:
Eureka Customer Service toll free at 1-800-282-2886, 8 a.m. to 7:30 p.m. (CST), Monday - Friday and 10 a.m. to 6:30 p.m. Saturday. Or visit our web site, www.eureka.com

*En Mexico llame al (55) 5343-4384

PLEASE RETAIN

We suggest you record the model, type and serial numbers below. They are located on the silver rating plate on your cleaner. For prompt and complete service information, always refer to these numbers when inquiring about service.

Model & Type _____

Serial No. _____

It is also important to keep your receipt as proof of date of purchase.

Index

Important Information	2
Assemble.....	3-4
Use	5-6
Accessories	7
How to Remove Blockages	8
Brush Roll.....	9
Brush Roll Belt.....	9
Filter.....	10
Dust Cup	11
Problem Solving	13
Warranty	14
Customer Order Form	16

To reduce the risk of electric shock, this appliance has a polarized plug (one blade is wider than the other). This plug will fit in a polarized outlet only one way. If the plug does not fit fully into the outlet, reverse the plug. If it still does not fit, contact a qualified electrician to install the proper outlet. Do not change the plug in any way.

GENERAL INFORMATION

The cleaner is designed to pick up dirt and dust particles. Avoid picking up hard or sharp objects with the cleaner to prevent hose clogs.

Service Information

The instructions in this booklet serve as a guide to routine maintenance. For additional service information, telephone our toll free number for the nearest Eureka Authorized Warranty Station. **You should know the model, type and serial number or date code when you call :**

USA : 1-800-282-2886

Mexico : (55) 5343-4384

Canada : 1-800-282-2886

If you prefer, you can write to Electrolux Home Care Products North America, Consumer Service, P O Box 3900, Peoria, Illinois, 61612, USA. In Canada, write to Electrolux Home Care Products Canada, 866 Langs Drive, Cambridge, Ontario N3H 2N7. Refer to The Eureka Warranty for complete service information.



DO NOT OIL the motor or brushroll at any time. The bearings are permanently lubricated and sealed.

Thermal Cut Off

This vacuum cleaner has a special thermostat that protects the cleaner in case of motor overheating. If the cleaner suddenly shuts off, turn the switch off and unplug the cleaner. Check the cleaner for a possible source of overheating such as a blocked hose or clogged filters. If these conditions are found, fix them and wait at least 30 minutes before attempting to use the cleaner. After the 30 minute period, plug the cleaner back in and turn on the switch. If the cleaner still does not run, then call 1-800-282-2886 for customer assistance.

IMPORTANT SAFEGUARDS

When using an electrical appliance, basic precautions should always be followed, including the following:

READ ALL INSTRUCTIONS BEFORE USING THIS WET PICKUP VACUUM CLEANER.

WARNING

To reduce the risk of fire, electric shock, or injury:

- Do not use outdoors or on wet surfaces.
- **Do not leave vacuum cleaner when plugged in.** Turn off the switch and unplug the electrical cord when not in use and before servicing.
- Do not allow to be used as a toy. Close attention is necessary when used by or near children.
- Use only as described in this manual. Use only manufacturer's recommended attachments.
- Do not use with damaged cord or plug. If vacuum cleaner is not working as it should, has been dropped, damaged, left outdoors, or dropped into water, have unit serviced before using.
- Do not pull or carry by cord, use cord as a handle, close a door on cord, or pull cord around sharp edges or corners. Do not run vacuum cleaner over cord. Keep cord away from heated surfaces.
- Do not use extension cords or outlets with inadequate current carrying capacity.
- Turn off all controls before unplugging.
- Do not unplug by pulling on cord. To unplug, grasp the plug, not the cord.
- Do not handle plug or vacuum cleaner with wet hands.
- Do not put any object into openings. Do not use with any opening blocked; keep free of dust, lint, hair, and anything that may reduce airflow.
- This vacuum cleaner creates suction and contains a revolving brush roll. Keep hair, loose clothing, fingers, and all parts of body away from openings and moving parts.
- Do not place cleaner on furniture or stairs as the brush roll may cause damage. Place cleaner on floor with the handle in storage position while using attachments.
- Do not pick up anything that is burning or smoking, such as cigarettes, matches, or hot ashes.
- Belt pulleys can become hot during normal use. To prevent burns, avoid touching the belt pulley when servicing the drive belt.
- Use extra care when cleaning on stairs.
- Do not use to pick up flammable or combustible liquids such as gasoline, or use in areas where they may be present.
- Store your cleaner indoors in a cool, dry area.
- Keep your work area well lighted.
- Unplug electrical appliances before vacuuming them.

SAVE THESE INSTRUCTIONS

How To Assemble



CAUTION: Assemble the cleaner completely before plugging into an electrical outlet.



CAUTION: Moving parts, stay clear of brush roll when plugging in.



NOTE: Features may vary by model yet all parts assemble the same.

Step A Remove Dust Cup

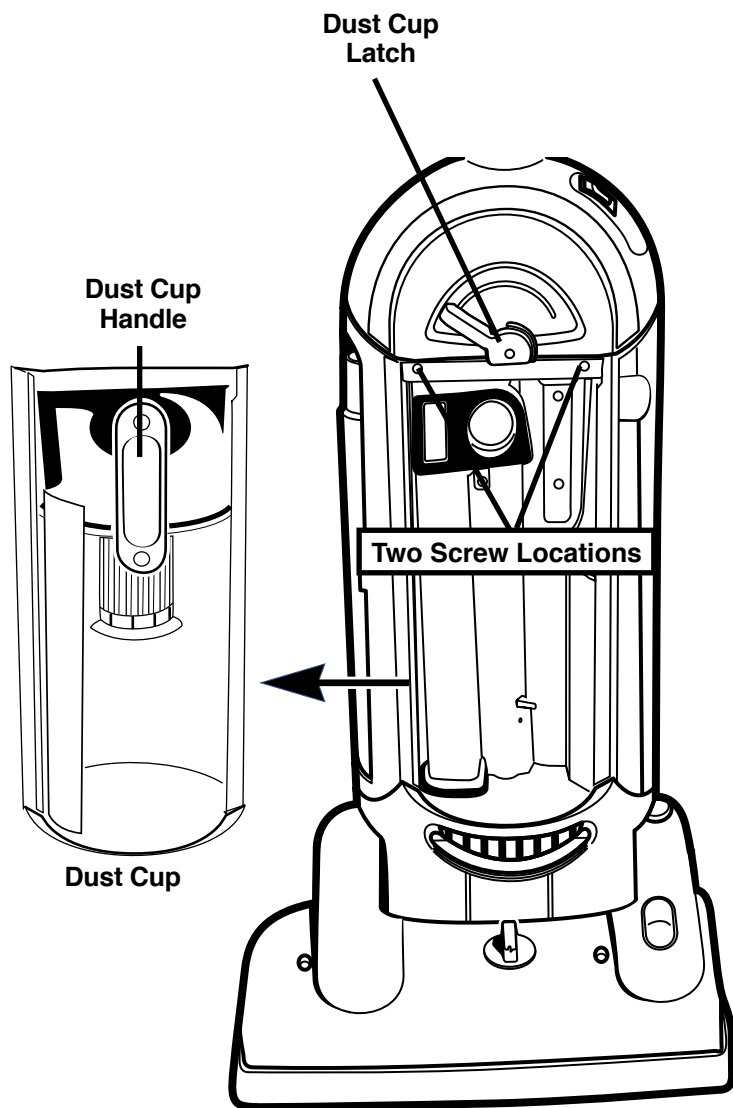

1. Remove dust cup from unit to expose the two screw installation locations. Release the dust cup by rotating the dust cup latch to the left. Pull out and up on the dust cup handle to remove from unit.

Step B Attach Handle



NOTE: Screws must be installed to properly secure the handle.

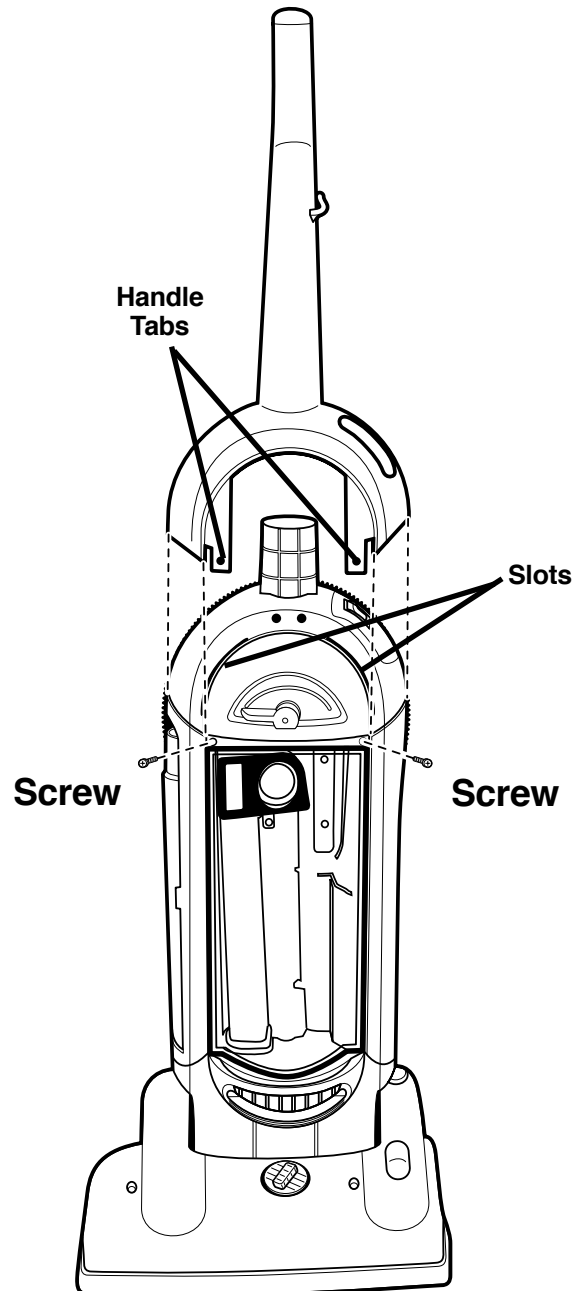

2. Position handle as above. Slide the handle down over the top of the unit, inserting handle tabs into slots on unit.
3. Find the two screws in the accessory bag included in the carton. To secure the handle on the unit, install the two screws.

Step C Replace Dust Cup

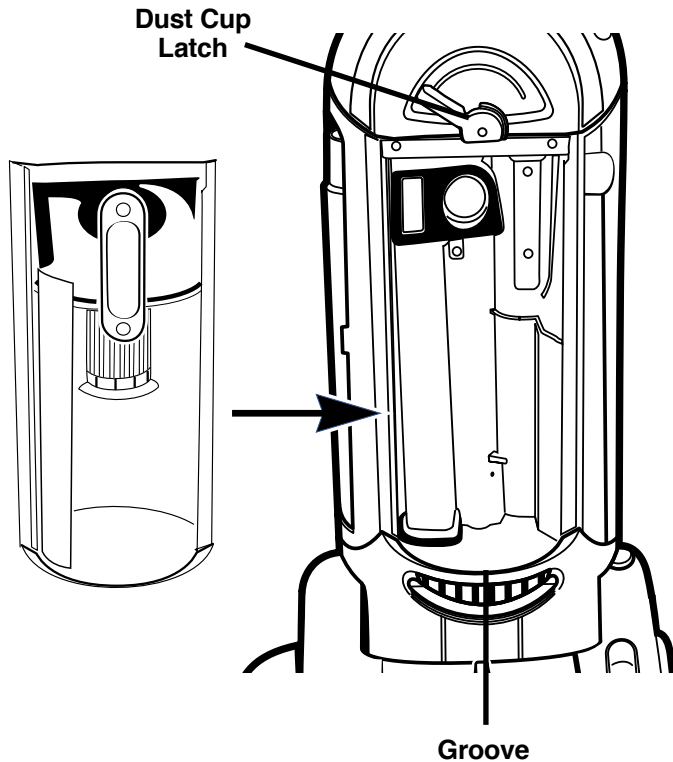

4. Replace dust cup by aligning front of the bottom of dust cup into groove on cleaner. Pivot dust cup up against cleaner and rotate the dust cup latch to the right to secure.

Step D Store Accessories

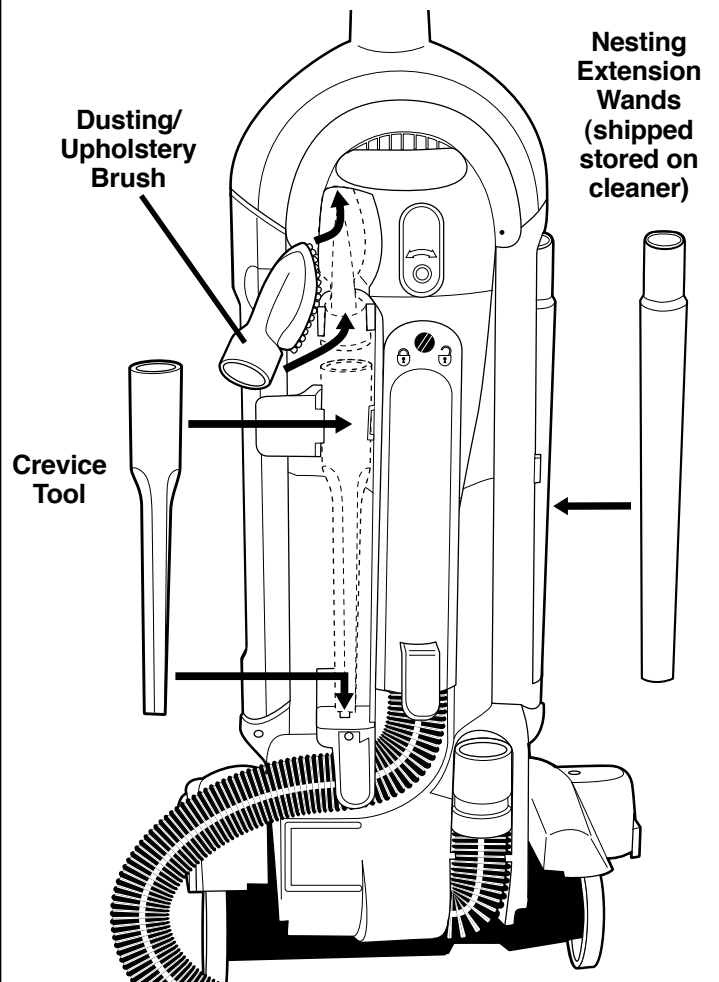

Step E Store Electrical Cord

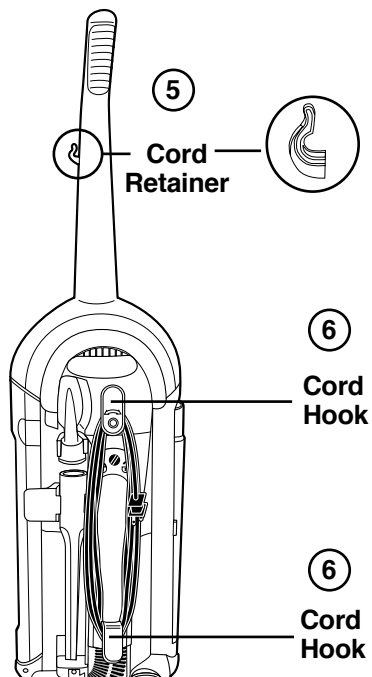



5. You will find your cord retainer on the handle above the upper cord hook. Firmly push the electrical cord down into the cord retainer. This will place the cord out of the way the next time you vacuum.
6. Next wind the cord around the two cord hooks on the back of the cleaner.
7. Secure the plug to the cord to prevent unwinding.

How To Use

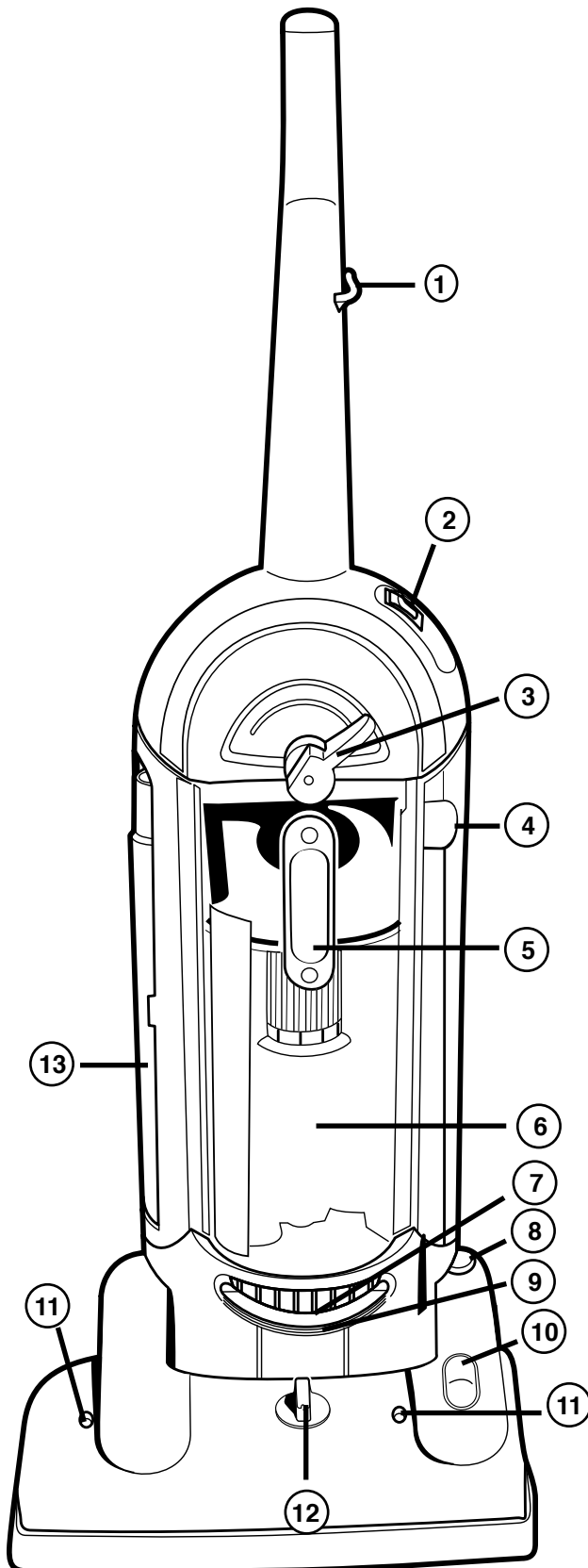

CAUTION: Do not plug in cleaner until you understand all controls and features.



1. **Cord Retainer.** To use, push electrical cord down into cord retainer.
 2. **ON/OFF Switch.** International symbol **I** means On, International symbol **O** means Off.
 3. **Dust Cup Latch.** When dust cup latch is pointing to the left, the dust cup compartment is unlocked. When dust cup latch is pointing to the right the dust cup is locked in place. See the locked/unlocked symbols on the unit.
 4. **HEPA Filter Compartment.** To open, slide HEPA filter door up and pull away from unit. To close, place HEPA filter door at top of opening pressing against unit, slide down into place.
 5. **Dust Cup Handle.** Use the handle to remove and replace the dust cup in the dust cup compartment.
 6. **Dust Cup Compartment.** To open, turn dust cup latch (3) to the left pointing to unlock symbol, then grasp dust cup handle (5) and pull dust cup out and away from unit. To close, place the front of the bottom of the dust cup in groove at the bottom of dust cup compartment, rotating dust cup up and against unit. Then turn dust cup latch to the right pointing to the lock symbol.
 7. **Stair Handle.** To use when cleaning stairs.
 8. **Handle Release.** Step on handle release. Pull handle back to a comfortable position. Press release again to lower handle further to clean under furniture.
 9. **Light Bulb Compartment.** To gain access to light bulb compartment remove the two screws in the lens.
 10. **Brush Roll Belt Window.** To check condition of belt watch to see if white dots on belt are moving through the window. This indicates the brush roll is turning.
 11. **Screws to Release Hood.** Remove these screws to release hood and give access to brush roll belt area.
 12. **Cleaner Height Setting.** The front of the cleaner has an adjustment that raises or lowers the cleaner base to match the type of floor surface. With the cleaner cord unplugged, set the adjustment to lowest setting for maximum carpet cleaning. If the cleaner is difficult to push, move adjustment to next highest setting until cleaner is comfortable to push. The brush roll must reach the carpet for effective cleaning. For ease in moving the adjustment knob, place handle in operating position and tilt cleaner back to remove weight from front wheels.
-  **WARNING:** Avoid injury. Keep loose clothing, hair, fingers, and all other parts of body away from any moving part (such as the revolving brush). Turn off the switch and unplug the cleaner before changing the cleaner height setting.
13. **Extension Wands.** Use these wands on the end of the hose for added cleaning reach.

How To Use (continued)

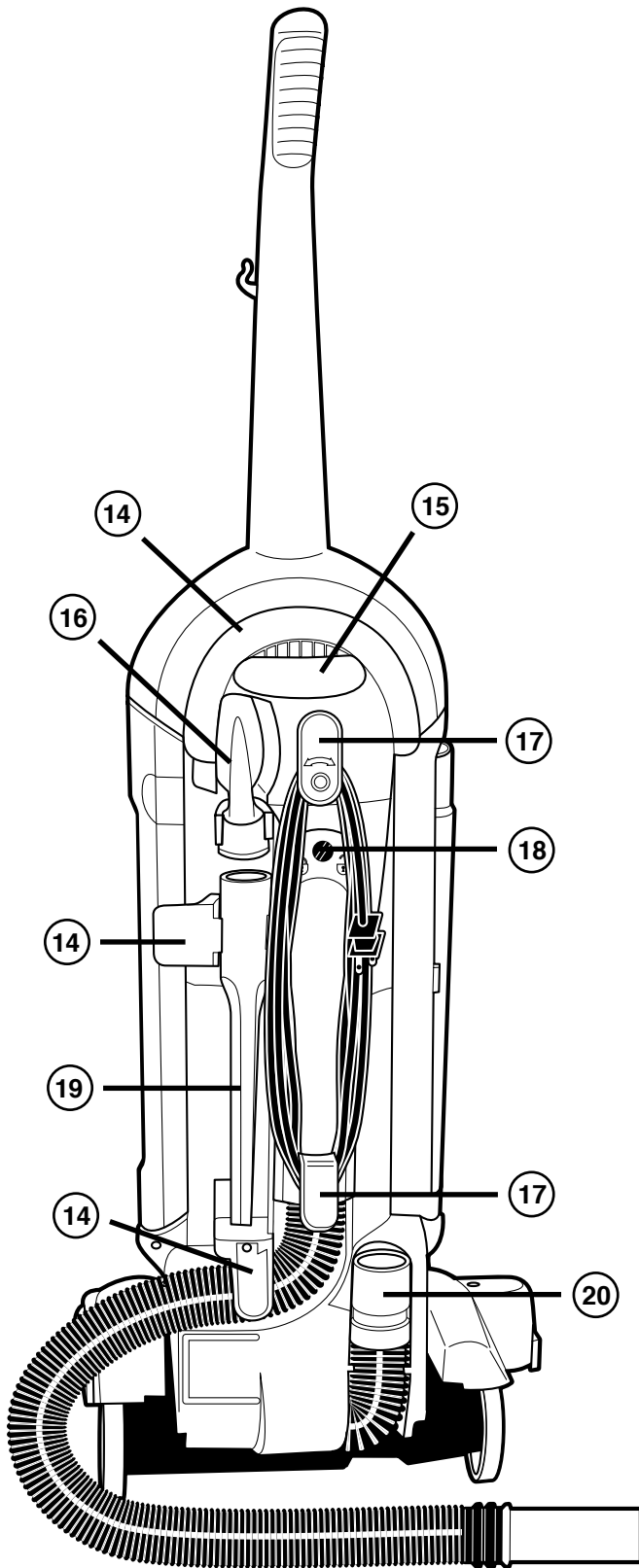

14. **Hose Retainers (3).** Place hose on retainers to store hose on unit.
15. **Carrying Handle.** Use this handle to carry unit from one place to another.
16. **Dusting/Upholstery Brush.** Store dusting brush here.
17. **Electrical Cord Hooks (2).** Wrap electrical cord around them to store electrical cord on unit. Top hook rotates down for quick release of the electrical cord. Rotate back up to store electrical cord.
18. **Clear Tube Quarter Turn Fastener.** Turn this fastener to the unlock position to remove the clear tube. To replace tube, place tube on the back of the unit and turn fastener to lock position.
19. **Crevice Tool.** Store crevice tool here.
20. **Hose Adapter.** Place the end of the hose into hose adapter for floor/carpet cleaning.

Thermal Cut Off

This cleaner has a special thermostat that protects the cleaner in case of motor overheating. If the cleaner suddenly turns off, follow this procedure:

1. Push on/off switch to off.
2. Unplug cleaner.
3. Check for source of overheating problem (i.e. full dust cup, clogged hose or clogged filters).
4. If a full dust cup, clogged hose or clogged filters are found, empty the dust cup, unplug the hose or replace the filters.
5. Wait at least 30 minutes before attempting to reuse the cleaner.
6. After 30 minute cool down period, plug the cleaner in and push the switch pedal. The cleaner should turn on.
7. If the cleaner still does not operate, call 1-800-282-2886 for customer assistance.

How To Use Accessories

CAUTION: Do not place cleaner on furniture or steps as the brush roll may cause damage. Place cleaner on floor with the handle in storage position while using accessories.

1. Remove hose from hose adapter on the back of cleaner.
2. Place desired accessory onto end of hose or wand.

Dusting/Upholstery Brush is for furniture, blinds, books, lamp shades, shelves, curtains, draperies, cushions and fabrics.

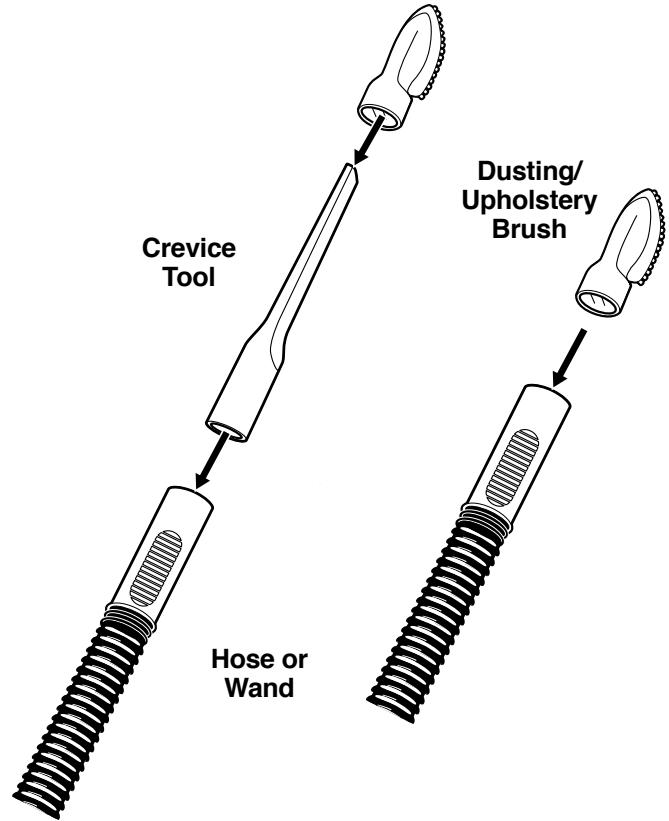
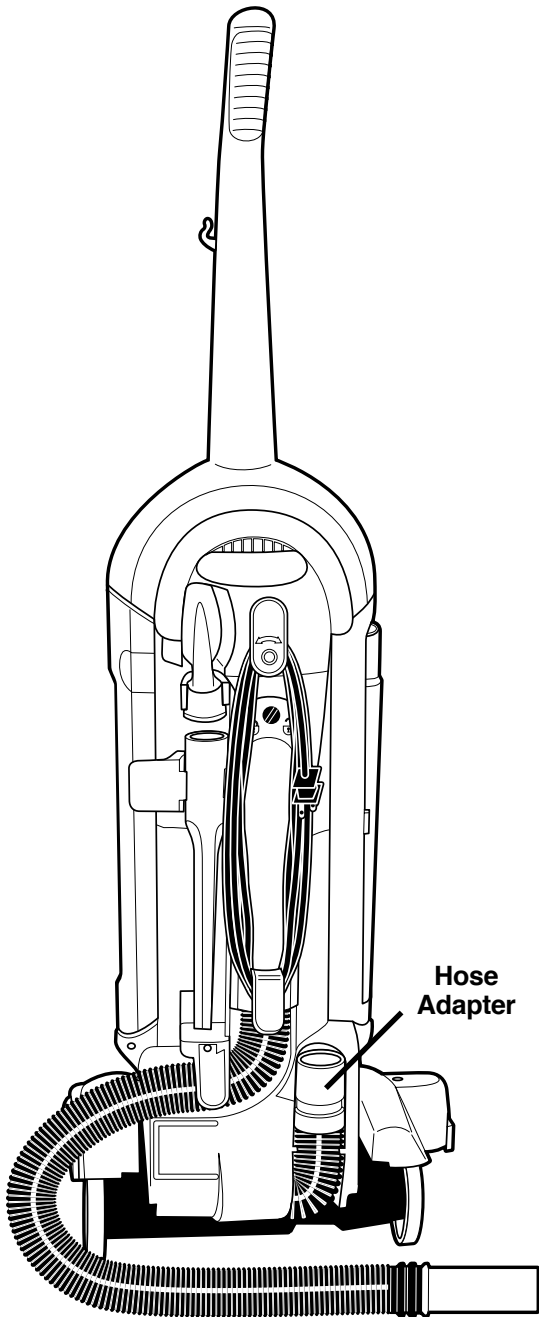

Crevice Tool cleans corners, baseboards, between cushions.

Extension wands (Some models use 1 wand)

Nested extension wands to add reach.

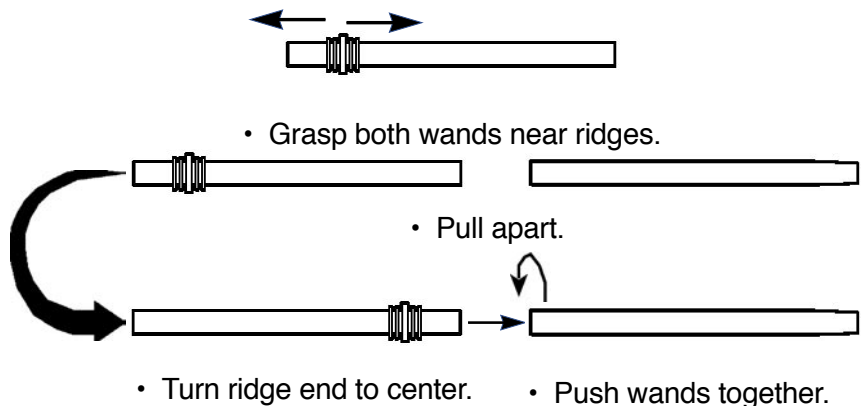

How to Check and Clear Hose Blockages

Low suction or poor pickup may be due to a blockage in the vacuum cleaner.

1. Remove hose from hose retainer and check suction at end of hose - if little or no suction, check dust cup. Empty if needed. If no improvement, proceed to step 2.

CAUTION: Turn off the switch and unplug the electrical cord before clearing hose.

2. Remove electrical cord from cord hooks. Disconnect the clear tube by turning quarter turn fastener to the right to release, then lift away from cleaner.

Check for any obstructions that may be in the tube. Any obstructions can be removed by using a blunt instrument to clear the tube.

3. To completely release hose from the unit, remove two screws.

Any obstructions can be removed by using a blunt instrument to clear the hose. Flexing the hose may help loosen the blockage.

After clearing blockage, reverse above steps to reassemble unit.

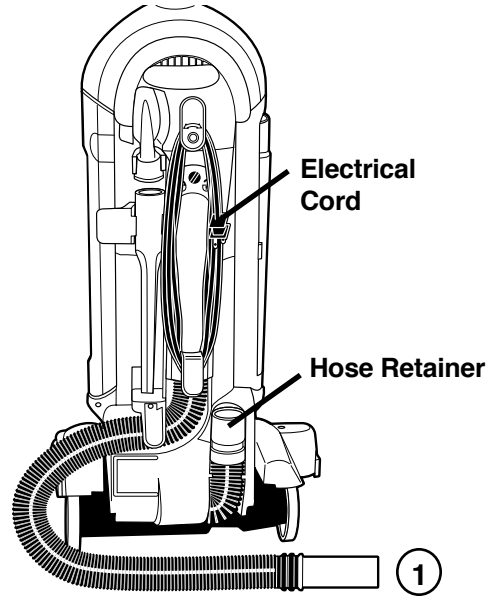

1. Remove hose from hose retainer and check suction at end of hose.

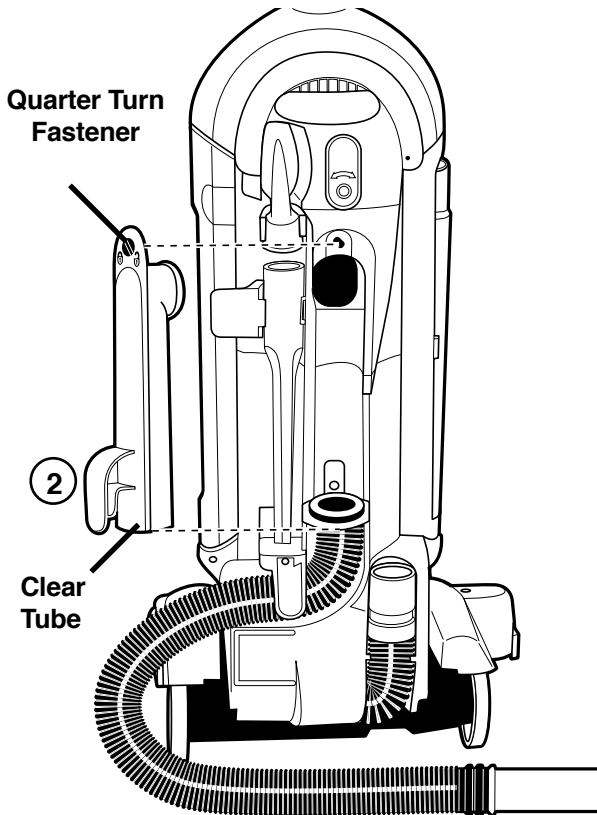

2. Disconnect clear tube.

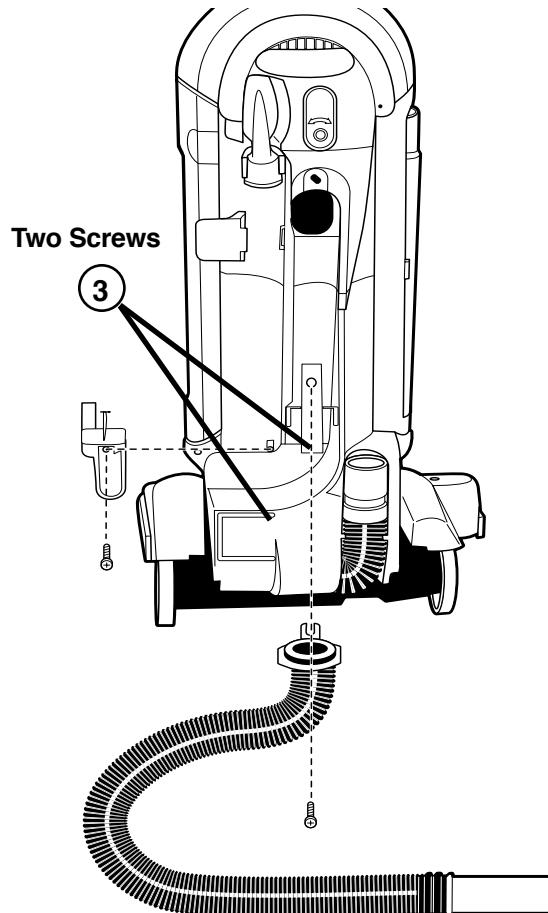

3. Release hose from unit.

How To Maintain

The instructions in this booklet serve as a guide to routine maintenance. To avoid unnecessary service calls, check the dust cup, belt, and brush roll often.

Brush Roll

The brush roll turns as it sweeps and combs the carpet nap. Remove hair and threads from the brush roll so it continues brushing the carpet. To maintain the most efficient cleaning, the bristles must touch the carpet. To test the bristle length, hold a ruler against the underneath side of the cleaner. If the bristles no longer touch the ruler, replace the brush roll.

Brush Roll Belt

The brush roll belt turns the brush roll to agitate, sweep, and comb the carpet nap. Check the belt regularly to be sure it is in good condition. Replace the belt if it stretches, cracks or loses tension. Cut away any hair or threads wound around the brush roll or the belt pulley because the buildup could cause the belt to rotate unevenly.

How To Replace Brush Roll Belt – Style EXT, PN 61120A

CAUTION: Turn off the switch and unplug the electrical cord before replacing belt. Belt pulleys can become hot during normal use. To prevent injury, avoid touching the motor pulley when checking the belt.

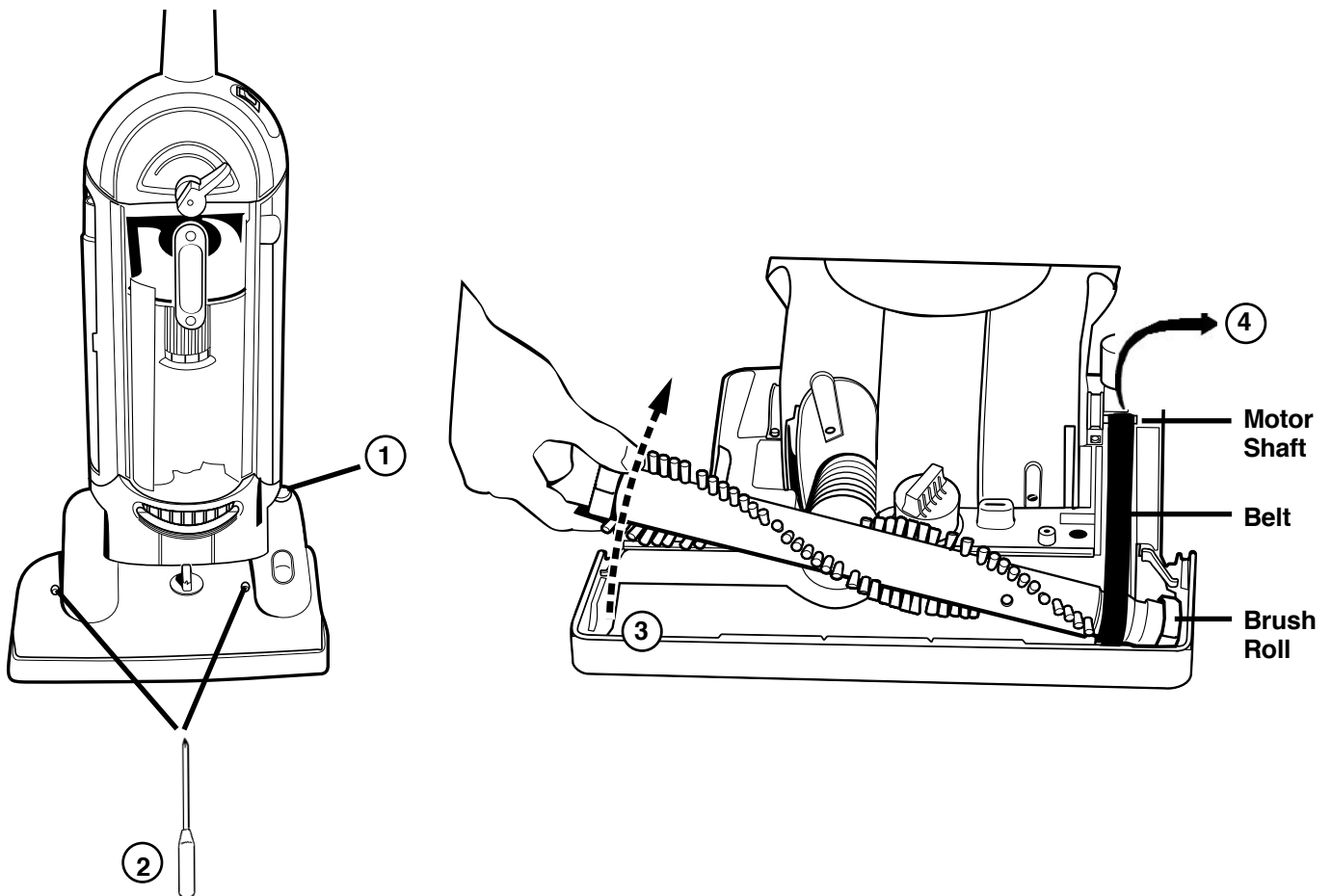

1. Lower handle to floor to change belt.
2. Remove two screws to release hood. Lift hood to remove.
3. Lift left end of brush roll.
4. Remove and discard belt.
5. Clean debris from brush roll area.

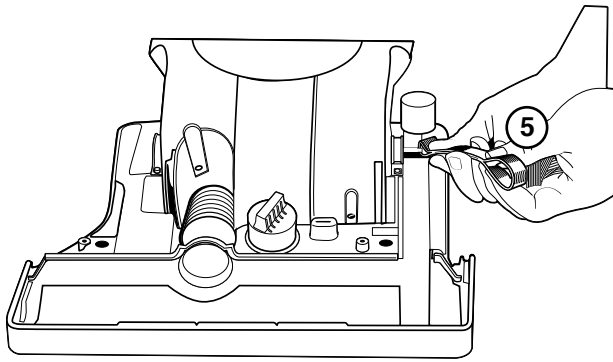

6. Place new belt around motor shaft.

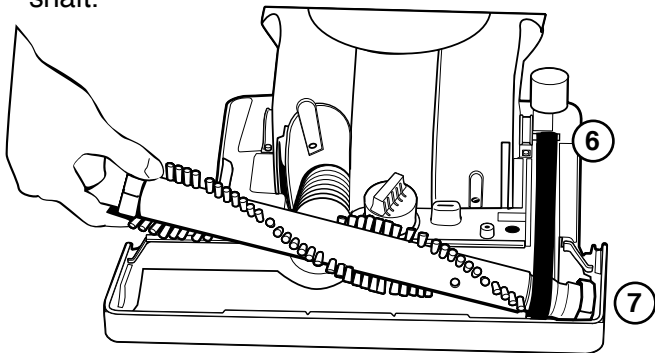

7. Place belt around brush roll pulley.
8. Pull right side of brush roll to stretch belt. Secure right end cap into base.

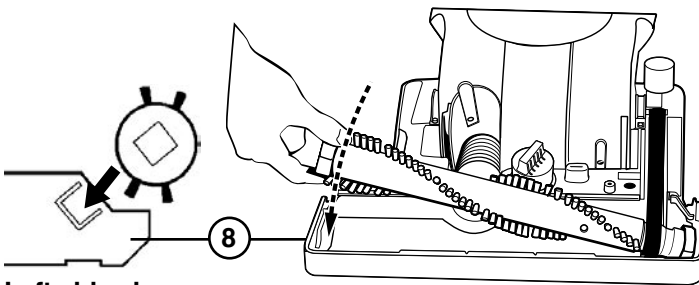

Left side view

9. Align left end cap with square in base. Push end cap into place; see left side view.

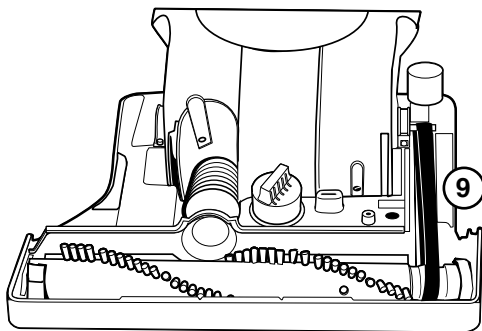

10. Rotate brush roll to seat belt.
11. Replace the hood. Make sure hood front is behind furniture guard.
12. Tighten screws.

Use replacement belt, Style EXT, PN 61120A.

To Change Dust Cup Pleated Filter:



NOTE: Turn off the switch and unplug the electrical cord before changing the Pleated Filter. Never operate the vacuum cleaner without the dust cup or the pleated filter assembly.

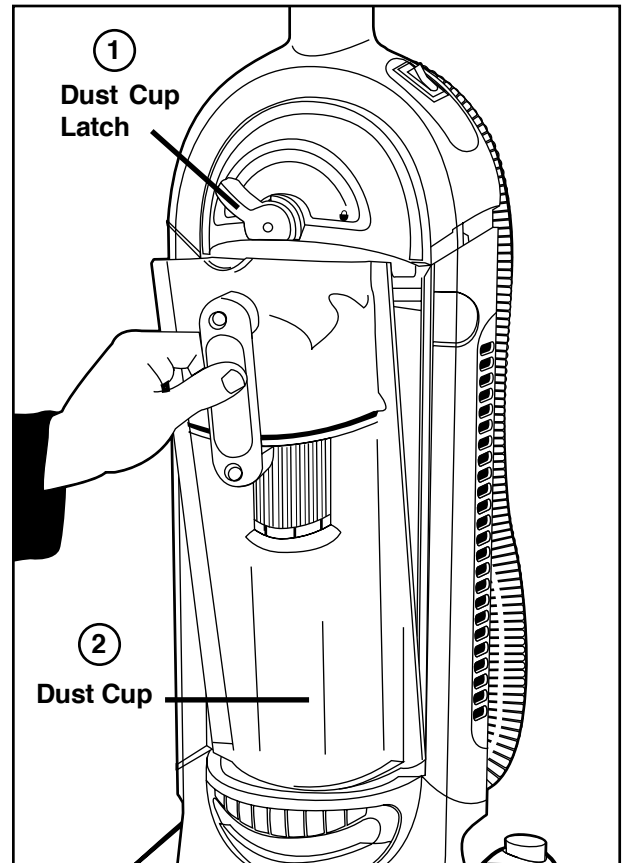

Release dust cup by rotating dust cup latch to the left pointing to the unlock symbol (⊖). Pivot dust cup out and away from cleaner and remove.

Remove cyclonic dust cup by pulling latch (1) forward, pivoting cyclonic dust cup out and lifting up. To replace cyclonic dust cup, put bottom of cyclonic dust cup in place by aligning tabs in slots and pivot top assembly back into place. Push down on latch (1), making certain that latch securely snaps and overlaps tabs at top of dust cup.

To maintain good performance, check and clean the Pleated Filter each time the dust cup is emptied and clean if needed. The filter can be cleaned by washing with mild detergent and warm water. Be sure pleated filter is completely dry before reinstalling.

To clean the Pleated Filter, Style DCF4, PN 62132:

1. Remove the gray filter assembly by grasping handle and lifting upward and out of the dust cup.
2. Grasp the pleated filter and turn counter clockwise to remove.
3. Lift pleated filter from cone and wash. Shake excess water from filter. **Do not submerge gray filter assembly – wipe only with a damp cloth.**
4. **When all parts are completely dry**, replace pleated and turn clockwise to lock in place.

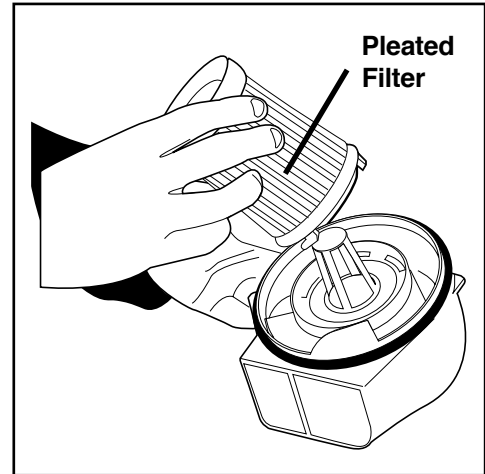
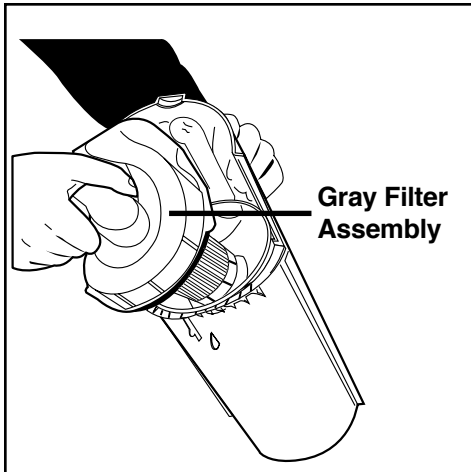

Use The Eureka brand replacement pleated filter, Style DCF-4, part number 62132.

FOR INSTRUCTIONS ON HOW TO REMOVE THE CYCLONIC DUST CUP FROM THE CLEANER BODY, REFER TO PAGE 10.

Emptying the Cyclonic Dust Cup:

It is clearly visible when the dust compartment is full and needs emptying. Remove dust cup from cleaner body and dump debris in a waste container.

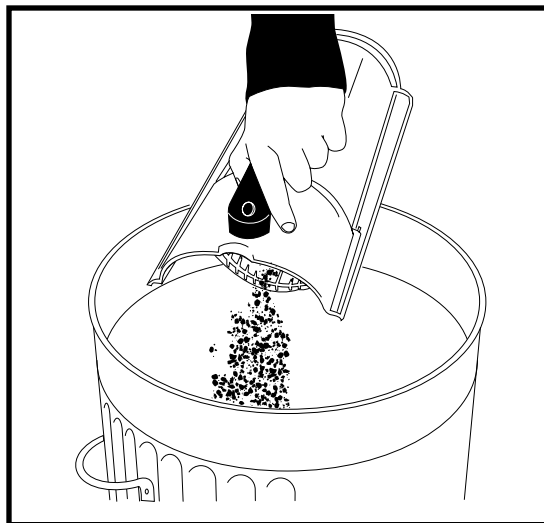

Reinstalling the Cyclonic Dust Cup:

To mount gray filter assembly into cleaner body, make certain gray filter assembly is fully seated in top of dust cup. Replace dust cup by aligning front of the bottom of dust cup into groove on cleaner. Pivot dust cup up against cleaner and rotate the dust cup latch to the right to secure.

 **CAUTION:** The dust cup can be washed in warm water, if desired, **but** strong detergents should not be used. Dry thoroughly before using again. **Do not submerge gray filter assembly, wipe only with a damp cloth.**

Cleaning and Replacing Filters

HEPA Filter, Style GE-1, PN 62134

Inspect the HEPA filter periodically and change as needed. For maximum efficiency, replace the HEPA filter periodically.

To Replace HEPA Filter

1. Push down on latch and pull out on HEPA filter door to remove.
2. Grasp filter and pull out.
3. Place new HEPA filter into cleaner.
4. To close, place HEPA filter door on top of bottom tab, pivot door up and press door against cleaner until it latches.

Use replacement HEPA filter supplied, Style GE1, part number, 62134.

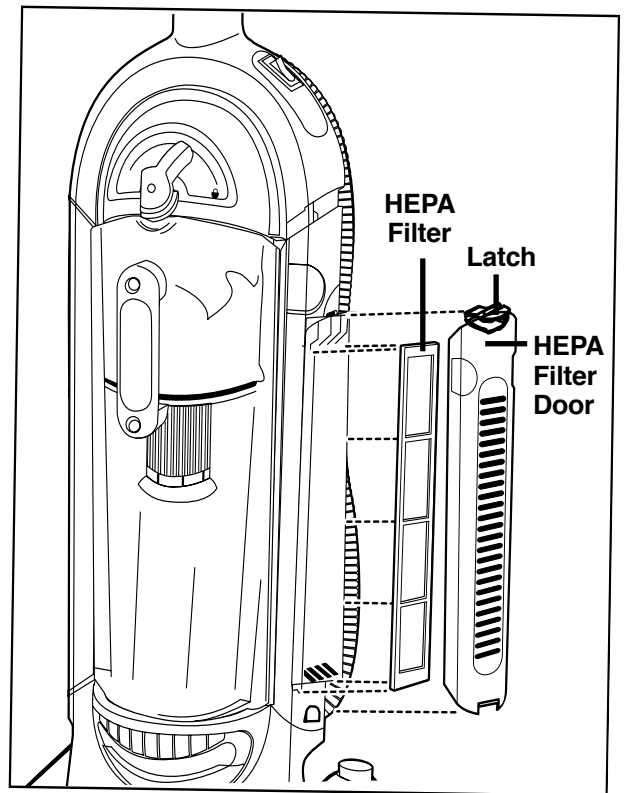

How To Change Light Bulb

CAUTION: Turn off the power switch and unplug the electrical cord before changing light bulb.

1. Lower handle to remove two screws from lens cover.
2. Pull lens cover from cleaner.
3. Support socket with one hand and pull light bulb straight out to release.
4. Place new light bulb into socket; push to secure.
5. Push light bulb and socket back so bulb will not touch lens cover.
6. Replace lens cover.
7. Secure with two screws.

Use replacement light bulb, 57940-3.

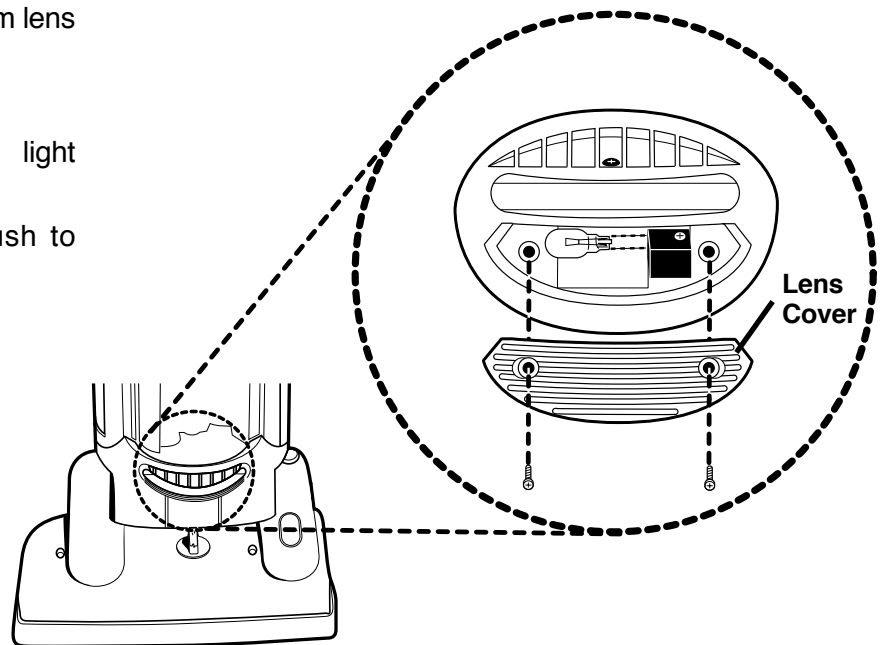

Problem Solving

NOTE: Turn off the switch and unplug the electrical cord before servicing.

PROBLEM	CAUSE	SOLUTION
Motor will not start.	<input checked="" type="checkbox"/> Electric Plug	<input type="checkbox"/> Push plug securely into outlet. <input type="checkbox"/> Try another outlet. <input type="checkbox"/> Check circuit breaker.
Motor suddenly stops.	<input checked="" type="checkbox"/> Thermal Cut Off	<input type="checkbox"/> Refer to page 6.
Does not clean the carpet or floor	<input checked="" type="checkbox"/> Dust Cup and Filter(s) <input checked="" type="checkbox"/> Belt <input checked="" type="checkbox"/> Brush Roll <input checked="" type="checkbox"/> Hose	<input type="checkbox"/> Empty the dust cup. Make sure the foam cone filter is clean and installed properly. Make sure dust cup is installed properly and dust cup latch secured. <input type="checkbox"/> Replace a cut, loose or out of shape belt. <input type="checkbox"/> Clean hair and thread from bristles and end cap area. Replace brush roll if bristles are worn. <input type="checkbox"/> Remove any clogs from the hose that restrict the airflow.
No suction at the end of the hose.	<input checked="" type="checkbox"/> Dust Cup and Filter(s) <input checked="" type="checkbox"/> Hose	<input type="checkbox"/> Empty the dust cup. Make sure the foam cone filter is clean and installed properly. Make sure dust cup is installed properly and dust cup latch secured. <input type="checkbox"/> Remove any clogs from the hose that restrict the airflow. Check both ends of the hose. (See pages 8)
Headlight not working.	<input checked="" type="checkbox"/> Light Bulb	<input type="checkbox"/> Replace light bulb.
Noise from the brush roll area.	<input checked="" type="checkbox"/> Brush Roll <input checked="" type="checkbox"/> Belt	<input type="checkbox"/> Remove hood and clean debris from the brush roll area. <input type="checkbox"/> Replace a cut, loose or out of shape belt.
Cleaner is hard to push.	<input checked="" type="checkbox"/> Cleaner Height Setting <input checked="" type="checkbox"/> Belt	<input type="checkbox"/> Turn adjustment knob to a higher position. Hint: Put handle in operating position. Tilt the cleaner back to raise the front wheels off floor. Then turn the knob. <input type="checkbox"/> Replace a cut, loose and out of shape belt.
Brush roll will not turn.	<input checked="" type="checkbox"/> Brush Roll <input checked="" type="checkbox"/> Belt	<input type="checkbox"/> Remove hood and clean debris from the brush roll area. <input type="checkbox"/> Replace cut, loose or out of shape belt.
Burning smell.	<input checked="" type="checkbox"/> Brush Roll <input checked="" type="checkbox"/> Belt	<input type="checkbox"/> Remove hood and clean debris from the brush roll area. <input type="checkbox"/> Replace cut, loose or out of shape belt.
Cleaning height knob will not turn.	<input checked="" type="checkbox"/> Cleaner Height Setting	<input type="checkbox"/> Hint: Put handle in operating position. Tilt the cleaner back to raise the front wheels off floor. Then turn the knob.
Missing parts or questions.	<input checked="" type="checkbox"/>	<input type="checkbox"/> Call 1-800-282-2886 for customer assistance.

THE EUREKA LIMITED WARRANTY

What This Warranty Covers

Your Eureka cleaner is warranted to be free from all defects in material and workmanship in normal household use for a period of two years. The warranty is granted only to the original purchaser and members of his or her immediate household. The warranty is subject to the following provisions.

What This Warranty Does Not Cover

- Parts of the cleaner that require replacement under normal use, such as disposable dust bags, filters, drive belts, light bulbs, brush roll bristles, impellers and cleaning.
- Damages or malfunctions caused by negligence, abuse, or use not in accordance with the Owner's Guide.
- Defects or damages caused by unauthorized service or the use of other than Genuine Eureka parts.

What The Eureka Company Will Do

The Eureka Company will, at its option, repair or replace a defective cleaner or cleaner part that is covered by this warranty. As a matter of warranty policy, the Eureka Company will not refund the consumer's purchase price.

Warranty Registration

Please fill out and return the warranty registration card accompanying your cleaner.

Obtaining Warranty Service

To obtain warranty service you must return the defective cleaner or cleaner part along with proof of purchase to any Eureka Authorized Warranty Station.

You will find the nearest location in the Yellow Pages, under "Vacuum Cleaners—Service and Repair." Be certain that the Warranty Station is "Eureka Authorized."

For the location of the nearest Eureka Authorized Warranty Station or for service information, telephone toll free:

USA: 1-800-282-2886

Mexico: (55) 5343-4384

www.eureka.com

Canada: 1-800-282-2886

If you prefer you can write to Electrolux Home Care Products North America, P.O. Box 3900, Peoria, Illinois 61612, USA. In Canada write to Electrolux Home Care Products Canada, 866 Langs Drive, Cambridge, Ontario N3H 2N7.

If it is necessary to ship the cleaner outside your community to obtain warranty repair, you must pay the shipping charges to the Eureka Authorized Warranty Station.

Return shipping charges will be paid by the Warranty Station. When returning parts for repair, please include the model, type, and serial number from the data plate on the cleaner.

Further Limitations and Exclusions

Any warranty that may be implied in connection with your purchase or use of the cleaner, including any warranty of Merchantability or any warranty for Fitness For A Particular Purpose is limited to the duration of this warranty. Some states do not allow limitations on how long an implied warranty lasts, so the above limitations may not apply to you.

Your relief for the breach of this warranty is limited to the relief expressly provided above. In no event shall Eureka be liable for any consequential or incidental damages you may incur in connection with your purchase or use of the cleaner. Some states do not allow the exclusion or limitation of incidental or consequential damages, so the above limitation or exclusion may not apply to you.

This warranty gives you specific legal rights. You may also have other rights which vary by state.

GENUINE
EUREKA PRODUCT

Questions & Answers about Genuine Eureka Products

Q: Why should I use only Genuine Eureka paper bags, belts, and parts in my Eureka vacuum cleaner?

A: Using Genuine Eureka Products, which are made to our exacting specifications and engineered with emphasis on quality, performance, and customer satisfaction, ensures the long life and cleaning efficiency of your vacuum cleaner. Overall, this saves you money and helps to keep your home clean.

Q: How can I be sure I am using only genuine Eureka products in my vacuum cleaner?

A: Typically, packaged products and paper bags can be identified by a "Genuine Eureka Product" symbol (see illustration above). For further identification assistance, you may call our toll-free number, 1-800-282-2886, for the location of a nearby Eureka Authorized Warranty Station.

Q: Are there any differences between "made to fit" or "imitation" and Genuine Eureka paper bags, belts, and parts?

A: Yes, there are some very important differences in materials, quality, and reliability. Many customers have mistakenly purchased "imitation" paper bags and parts while thinking they purchased genuine. Unfortunately, many of these customers discovered the differences after they experienced related difficulties.

For Genuine Eureka Value, Accept No Imitations!
ELECTROLUX HOME CARE PRODUCTS NORTH AMERICA

Bloomington, Illinois 61701

Household Warranty
abs 190

**Questions?
Call
1-800-282-2886**

Accessory Items in This Carton

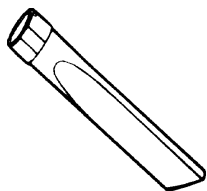

1 crevice tool



**1 dusting/
upholstery brush**



1 nesting wand



**1 hardware
package (2 screws)**

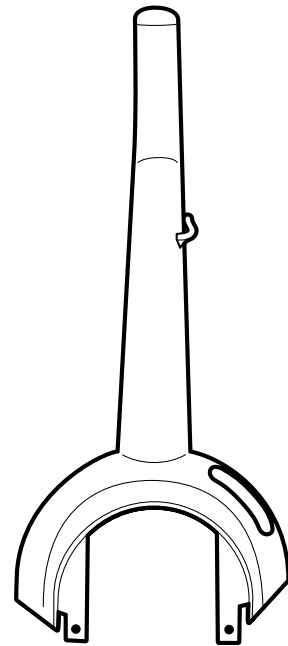

**1 vacuum
cleaner handle**

Thank you for selecting a Eureka brand cleaner.

**Don't Forget to Use Genuine Eureka
Belts & Filters**

www.eureka.com

**CAUTION: Damages caused by the use of other
brand bags and belts are not covered
by the Limited Warranty.**

ORDER FORM



Electrolux Home Care Products, Ltd.
P.O. Box 3900 • Peoria, IL 61612

MODEL NUMBER **TYPE**

SERIAL NUMBER

IMPORTANT: Be sure to include your model, type, and serial numbers. These numbers may be found on the rating plate.

SOLD TO:

Name

Address

City State Zip

Telephone (Day)

Telephone (Eve)

Fax

SHIP TO:

Name

Address

City State Zip

Telephone (Day)

Telephone (Eve)

Fax

PAYMENT (no C.O.D. Orders)

Check or money order. Do not send currency.
Payable to Electrolux Home Care Products North America

VISA DC MC AMEX

ACCT. NUMBER

EXPIRATION DATE

SIGNATURE (full name as shown on acct.)

TO ORDER:



By Phone: 1-800-282-2886

Hours: Call Monday-Friday
8:00 am - 7:30 pm CST;
Saturday 10:00 am - 6:30 pm CST
(Please call the same number for
answers to problems or questions
in the USA and Canada)

**En Mexico llame al:
(55) 5343-4384**



By FAX: 1-309-589-7583



By Mail:

Simply fill out this Order Form.
Please be sure to include day and
evening phone numbers.



**ONLINE
www.eureka.com**

Genuine Eureka Bags, Belts and Filters

		Part No.	Qty.	Price (USD)*	Total
	DISPOSABLE BAGS - STYLE GE-1 (PACKAGE OF THREE PLUS ONE REPLACEMENT MICRON FILTER)	62423		\$6.99	
	STYLE U BELT	61120B		\$2.99	
	HEPA FILTER CARTRIDGE, GE-1	62134		\$15.99	
	DUSTCUP FILTER DCF-4 (FOR BAGLESS MODEL)	62132		\$14.99	
	MICRON FILTER ASSEMBLY	71117A		\$2.99	

Accessories/Tools

	EXTENSION WAND	71119-1		\$8.49	
	COMBINATION TOOL	60990-3		\$4.99	
	CREVICE TOOL	28497-355N		\$1.99	
	TURBO NOZZLE	28612A		\$14.99	

Hoses

	HOSE ASSEMBLY	61440-5		\$14.99	
--	---------------	---------	--	---------	--

Brushroll

	BRUSHROLL ASSEMBLY (FOR BAGGED MODEL)	60844-5		\$12.99	
	BRUSHROLL ASSEMBLY (FOR BAGLESS MODEL)	62352-2		\$10.99	

Miscellaneous Parts

	LIGHT BULB	57940-2		\$1.49	
--	------------	---------	--	--------	--

TOTAL (*prices subject to change without notice)					
TAX (add state tax & local taxes as required by law)					
POSTAGE & HANDLING CHARGE (within USA)					\$5.50
T O T A L E N C L O S E D					

BON DE COMMANDE

FORMULAIRE DE PEDIDO DEL CLIENTE



Electrolux Home Care Products
P.O. Box 3900 • Peoria, IL 61612

N° DE MODELE **TPE** **N° DE MODELO**
N° DE NUMERO **SERIE** **NUMERO** **SERIE**
IMPORTANTE: Assurez-vous d'inclure le type, les numéros de modèle et de série que vous trouverez sur la plaque signalétique. **IMPORTANT:** Asegúrese de incluir los números de modelo, tipo y serie. Estos números se encuentran en la placa de datos.

VENDU A: - VENDIDO A: Nom Adresse Ville Province Estado Code postal Cuidad

ENVOYÉ A: - ENVIAR A: Nom Adresse Ville Province Estado Code postal Cuidad

Téléphone (jour) Téléphone (dia)
 Téléphone (soir) Téléphone (noche)
 Télécopieur Fax

PAIEMENT (pas de commandes en PORT DU) (no se aceptan ordenes contra reembolso)

Cheque ou mandat. N'envoyez pas d'espèces.
 Cheque o giro postal. No envíe dinero en efectivo.
 Payable à : Electrolux Home Care Products North America
 Pagadero a : Electrolux Home Care Products North America

VISA DC MC AMEX
 NUMERO DE COMPTE - NUMERO CUENTA

SIGNATURE (nom complet comme sur le compte) FIRMA (nombre completo como aparece en la cuenta)
 POUR COMMANDER : - PARA ORDENAR:
Par téléphone : 1-800-282-2886
HEURES : Du lundi au vendredi entre 8 h et 17 h 18 h 30, heure normale de Centre. le samedi entre 10 h à 30, heure normale de Centre. Pour obtenir des réponses à vos questions ou problèmes aux E.-U. et au Canada, veuillez composer le même numéro.
Par téléphone : 1-309-589-7583
Par télécopieur : 1-309-589-7583
Par la poste : Remplissez simplement ce bon de commande. Assurez-vous de mentionner vos numéros de téléphone - jour et soir.
Por correo: Simplemente llene el Formulario de Pedido. Por favor incluya números de teléfono para llamar durante el día o en la noche.
En Ligne : - Por internet: www.eureka.com

PAR TELEPHONE: 1-800-282-2886
HORAS: Llamada de lunes a viernes 8:00 am - 7:30 pm (hora estándar central). Por favor llame a ese mismo número en caso de problemas o preguntas en los Estados Unidos y Canadá. En México llame al (55) 5343-4384.
Par télécopieur : 1-309-589-7583
Par la poste : Remplissez simplement ce bon de commande. Assurez-vous de mentionner vos numéros de téléphone - jour et soir.
Por correo: Simplemente llene el Formulario de Pedido. Por favor incluya números de teléfono para llamar durante el día o en la noche.
En Ligne : - Por internet: www.eureka.com

TOTAL (les prix peuvent être modifiés sans préavis)		TOTAL (precios sujetos a cambio sin previo aviso)	
TAXE (taxes locales et autres requises par la loi)		IMPUESTOS (agregue impuesto estatal e impuestos locales según exija la ley)	
FRAIS DE MANUTENTION ET D'ENVOI (aux E.-U.)		GASTOS DE ENVIO (dentro de los EE.UU.)	
TOTAL C I - J O I N T		TOTAL I N C L U I D O	

Sacs, Courroies et Filtres Eureka Authentiques	N° pièce	Qté Prix (USD)	Parte No.	Cant. Precio (USA)	Total
BOLSAS DESECHABLES - ESTILO GE-1 (PAQUETE DE TRES MAS UN FILTRO DE MICRONES DE RESPUESTO) SACS JETABLES - STYLE GE-1 (PAQUET DE TROIS, AVEC UN FILTRE MICRON DE RECHANGE)	62423	\$6.99			
CORREA ESTILO U	61120B	\$2.99			
FILTRO HEPA A CARTUCHO, GE-1	62134	\$15.99			
FILTRO DCF-4 PARA RECIENTE PARA POLVO (PARA MODELO SIN BOLSA)	62132	\$14.99			
ENSAMBLAJE DEL FILTRO DE MICRONES	71117A	\$2.99			
TUBO DE EXTENSION	71119-1	\$8.49			
UTENSILIO COMBINADO	60990-3	\$4.99			
UTENSILIO PARA HENDIDURAS	28497-355N	\$1.99			
BOQUILLA TURBO	28612A	\$14.99			
Mangueras / Tuya					
ENSAMBLAJE DE LA MANGUERA	61440-5	\$14.99			
Rouleurs-brosses - Cepillos circulares					
ENSAMBLAJE DEL CEPILLO CIRCULAR (PARA MODELO CON BOLSA)	60844-5	\$12.99			
ENSAMBLAJE DEL CEPILLO CIRCULAR (PARA MODELO SIN BOLSA)	62352-2	\$10.99			
Piezas miscelaneas / Partes divers					
FOCO DE LA LUZ	57940-2	\$1.49			
AMPOULE					